

THIS DRAWING IS UNPUBLISHED. RELEASED FOR PUBLICATION 20
 © COPYRIGHT 20 BY - ALL RIGHTS RESERVED.

REVISIONS				
P	LTR	DESCRIPTION	DATE	APVD
A1		REVISED PER ECO-12-010330	04JUN2012	DD RB
B		REVISED PER ECO-15-004568	23MAR2015	JM RB

- INSTRUCTION SHEET FOR ASSEMBLY AND DISASSEMBLY OF AMPSEAL 16 CONNECTORS: 408-8623.

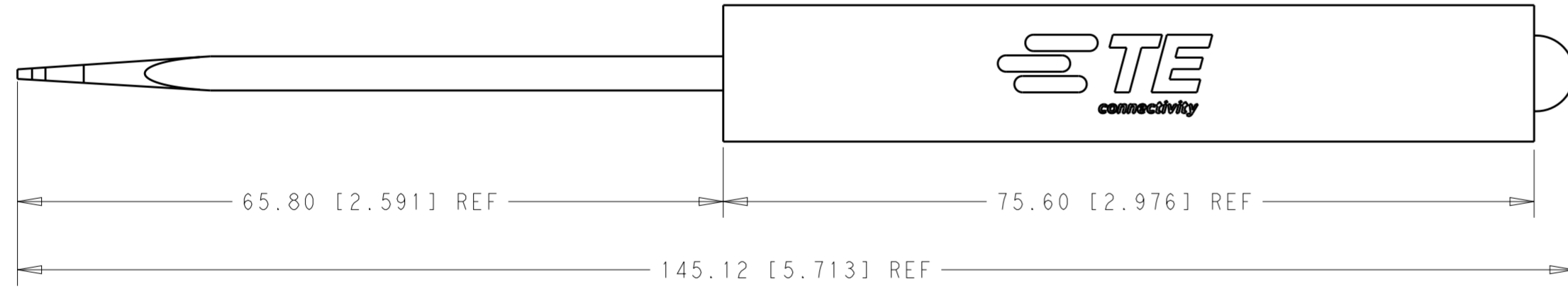
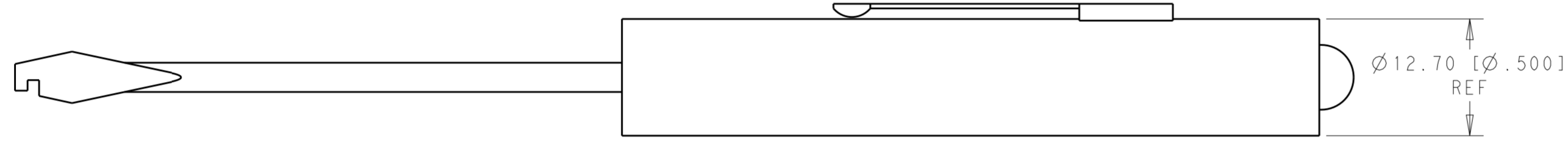

776441-1 SHOWN

776441-1
TE PART NUMBER

THIS DRAWING IS A CONTROLLED DOCUMENT.		DWN R. COLE	15JAN2002		
DIMENSIONS: mm [INCHES]		CHK M. TRULL	15JAN2002		
TOLERANCES UNLESS OTHERWISE SPECIFIED:		APVD M. TRULL	15JAN2002	NAME EXTRACTION TOOL, TPA AND CONTACT, AMPSEAL 16	
0 PLC ±	1 PLC ±	PRODUCT SPEC		SIZE	
2 PLC ±	3 PLC ±	108-2184		CAGE CODE	
4 PLC ±	ANGLES ±	APPLICATION SPEC		DRAWING NO	
FINISH -	FINISH -	114-13065		RESTRICTED TO	
MATERIAL -	MATERIAL -	WEIGHT 15.6g		A200779	
CUSTOMER DRAWING		SCALE 2:1		SHEET 1 OF 1	
				REV B	